

they will work with the original, unscaled geometry rather than the visually apparent size. This disconnect between appearance and data causes many modeling problems for beginners.

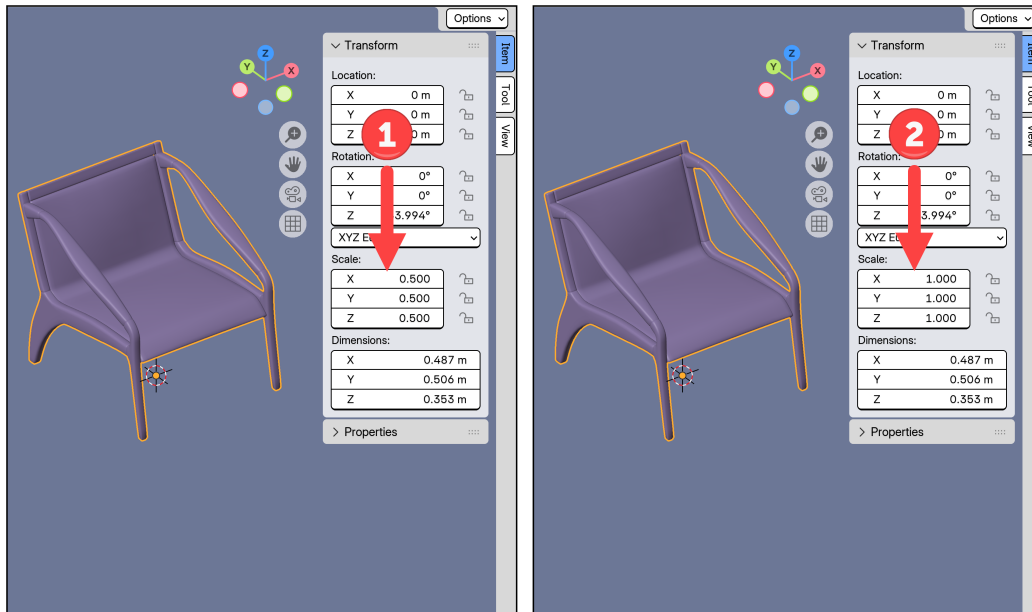

Figure 1.21 - Object Data After Applying Scale

Figure 1.21 reveals the same object after applying scale, where all scale values have been reset to 1.0 while the object maintains its visual size (2). This "clean" state ensures that all tools and modifiers will work with the geometry as it appears, eliminating unexpected behavior and providing predictable results. The application process has essentially redefined the object's base state to match its current appearance.

The strategic application of transformations becomes crucial when preparing objects for specific workflows. Tools that require clean object data include:

- **Bevel modifiers** - Need uniform scale values to create consistent edge widths
- **Array operations** - Require clean transformations for predictable spacing and alignment
- **Boolean functions** - Depend on accurate geometry data for reliable cutting and joining operations

- **Strategic placement:** Proper pole positioning maintains predominantly quad-based meshes
- **Topology transitions:** Essential for handling complex forms that require edge flow changes

Understanding how to use poles effectively allows you to maintain clean topology while accommodating the inevitable structural transitions required by sophisticated modeling projects.

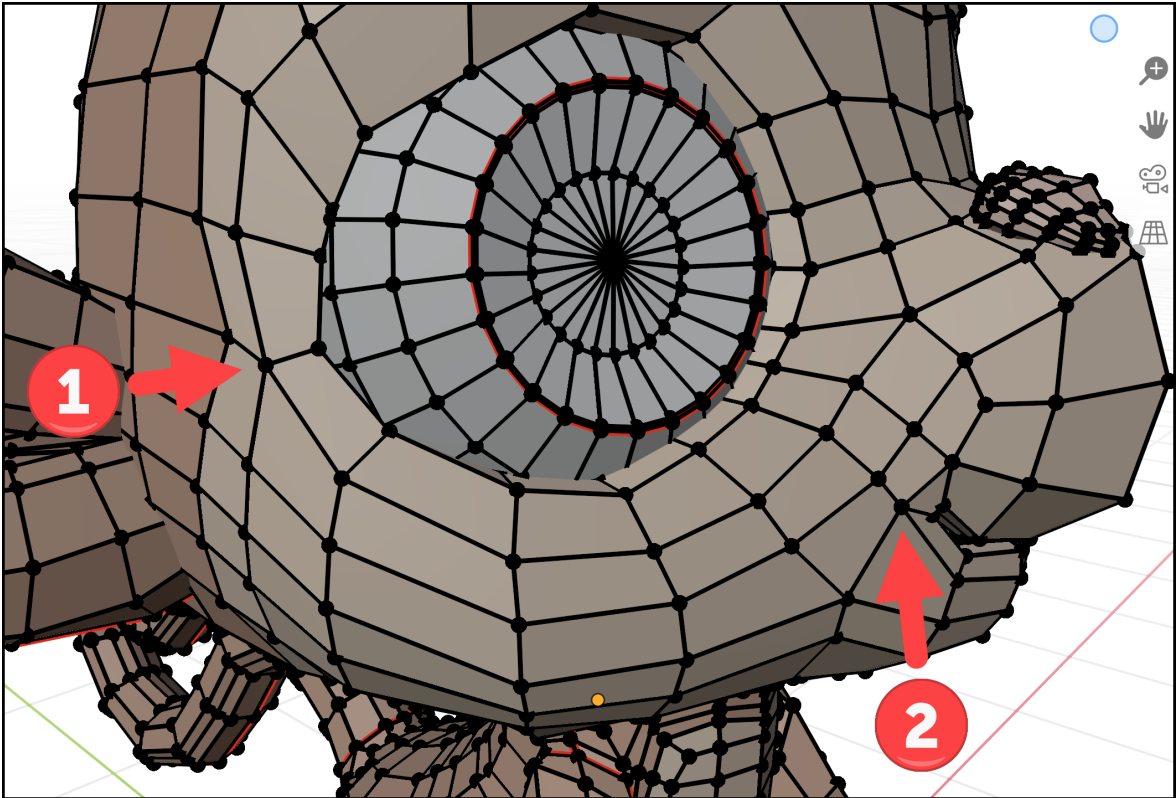

Figure 2.12 - Identifying a 5-Edge Pole

The mathematical advantages of quads extend beyond modeling convenience. Quad-based meshes subdivide predictably, creating new quads at each subdivision level. This property makes them ideal for working with *Subdivision Surface* modifiers, which rely on regular patterns to generate smooth results. Rendering engines also optimize for quad-based geometry, often producing better performance and more predictable results.

Even in simple shapes, you can easily require the use of a 5-Edge Pole (1)(2)(Figure 2.13).

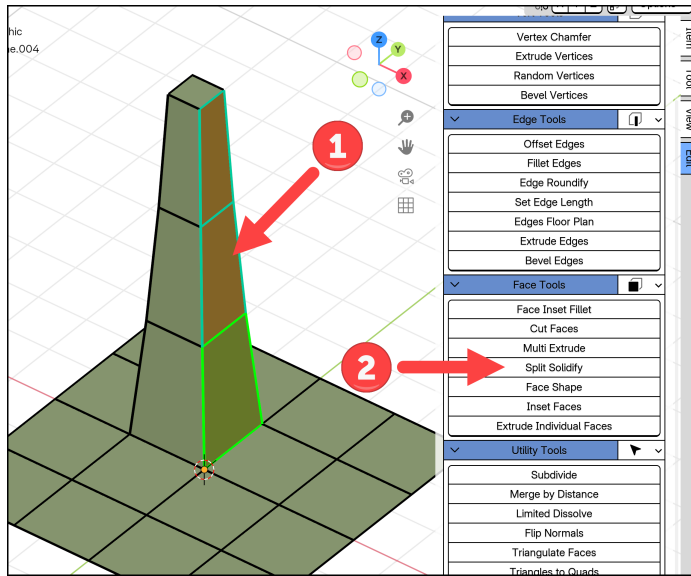

Figure 5.16 - Selecting faces for the Split Solidify

The original stepped model remains intact with the selected faces duplicated, with a new object appearing as a separate entity with the specified depth added by the automatic *Solidify* modifier application (1)(Figure 5.17).

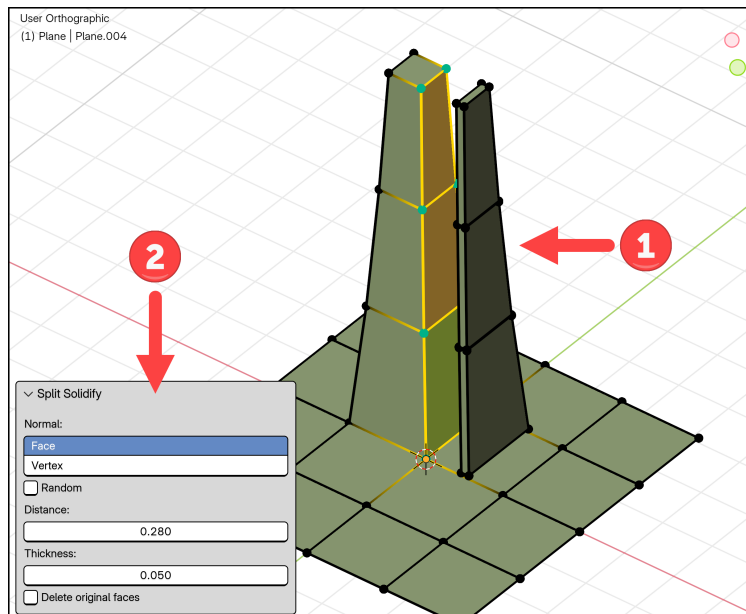

Figure 5.17 - Resulting faces from the Split Solidify

Face Inset Fillet combines inset operations with automatic filleting, creating recessed details with rounded edges in a single operation. This tool streamlines the creation of sophisticated surface details that would typically require multiple tool applications and manual refinement.

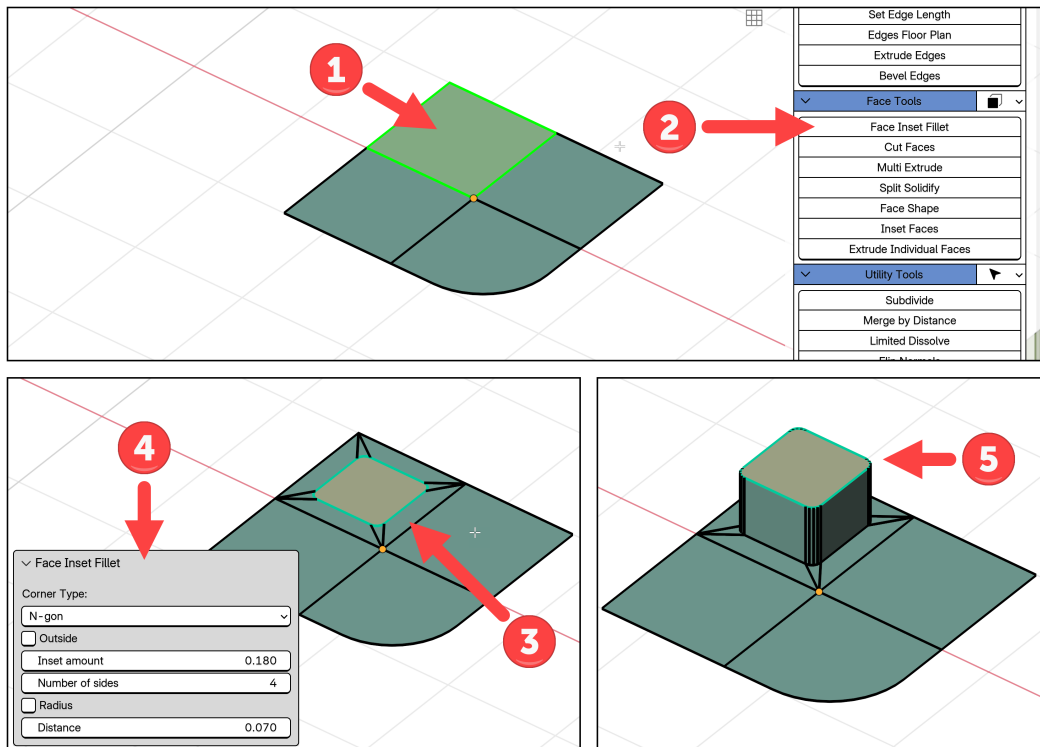

Figure 5.19 - Face Inset Fillet Example

The workflow demonstrates how this combined approach accelerates detail creation (**Figure 5.19**):

- 1 → Select a face from any model in your scene
- 2 → Start the *Face Inset Fillet* tool from the *Edit Mesh Tools* panel
- 3 → The tool automatically creates an inset with rounded corners, eliminating the sharp transitions typical of standard inset operations
- 4 → Adjust the settings from the *Operator Panel* to control the inset distance and corner radius

7 → Pick the coordinates for each required point using the same selection method

This systematic approach allows you to define precise geometric relationships between objects. Each point serves a specific mathematical purpose in calculating the transformation matrix needed for perfect alignment.

Now we'll apply this Expert Mode workflow using the same pyramid and angled plane from our earlier example. This scenario demonstrates how precise pivot control enables exact positioning that would be difficult to achieve through automatic methods.

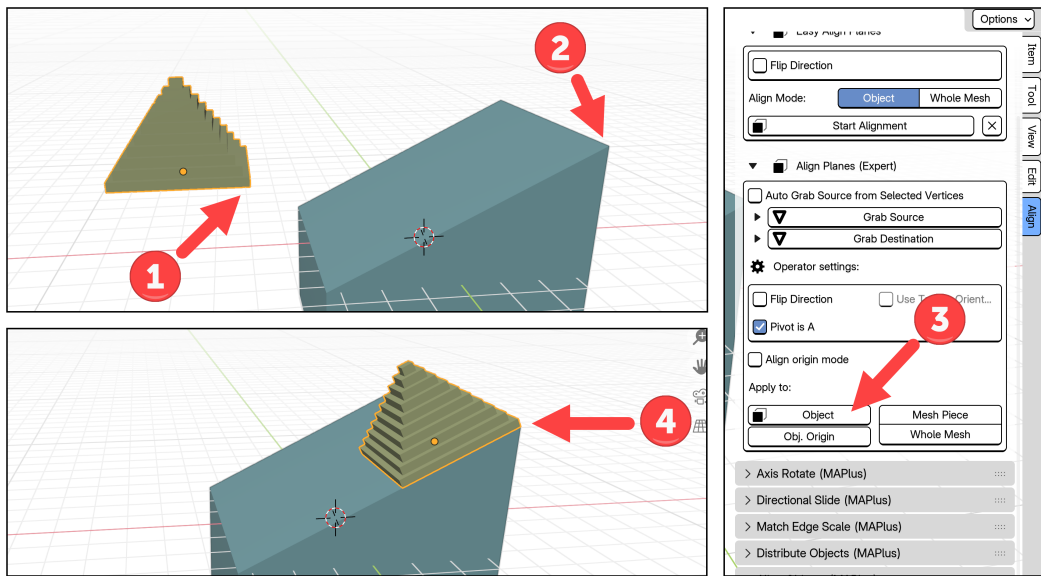

Figure 7.15 - Pyramid Aligned Using Expert Mode Pivot Control

The pyramid needs to align with the angled plane surface, but we want specific control over which vertex touches the plane and how the pyramid is oriented. Expert Mode gives us this granular control through point-based definitions (**Figure 7.15**):

- 1 → In the source object (pyramid), select the bottom vertex that should contact the plane and capture this as point A using the **Grab Source** button. Select two additional points for B and C.
- 2 → In the destination object (angled plane), select the center vertex or desired contact point and capture this as point A using **Grab Destination**. Select two additional points for B and C, matching the order from your Source.