

Another way to cancel the selection area for your *Saved View* is with the ESC key. This key works as a quick way to cancel any command or tool in AutoCAD.

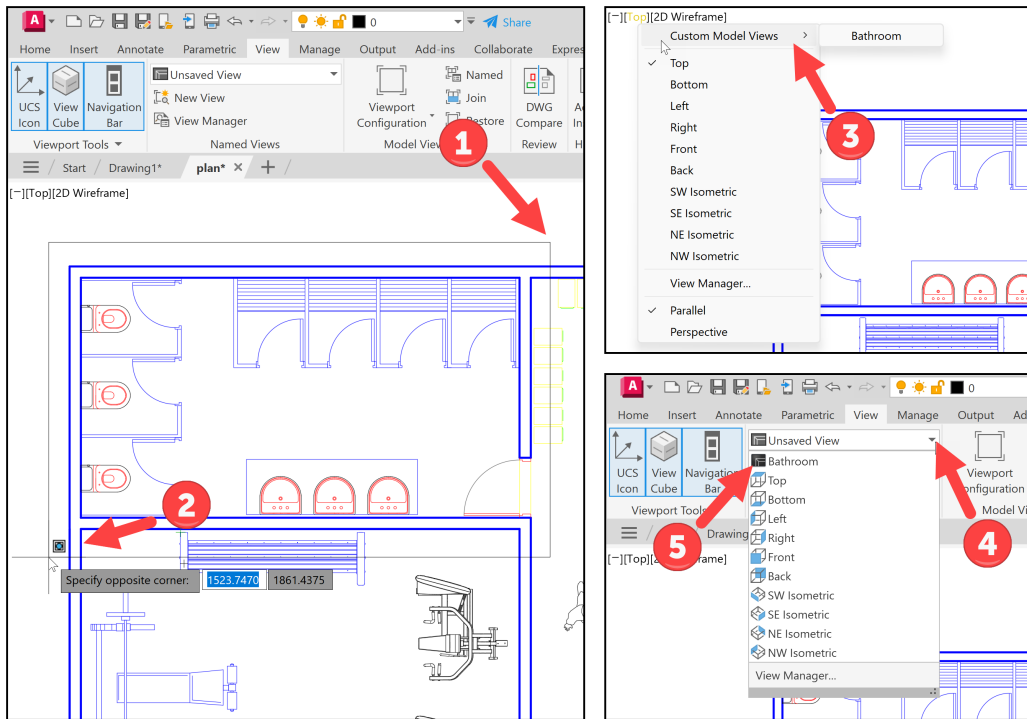

Figure 1.15 - Selecting the view area

In **Figure 1.15**, you'll see the steps to select a region for your *Saved View* and how to access it:

- 1 → Click the icon (*Step six from Figure 1.14*) to start selecting an area, then click a point to define one corner of the region.
- 2 → Move the cursor to establish the opposite corner and form a rectangular area—this will be your *Saved View*. Confirm by clicking the OK button in the *View Manager*.
- 3 → To use your saved view, left-click on the view name at the top left (*Top*) to open the *Custom Model Views* section, which displays a list of all your saved views. Assign meaningful names to each view to easily identify them in projects with many views.
- 4 → Access the saved views directly from the *View tab*.
- 5 → This list includes all your *Saved Views* alongside the default AutoCAD views.

5 → If you need to make changes to the alignment of your cell, you can use the Align options.

Using this type of data requires you to resize the height of your cells.

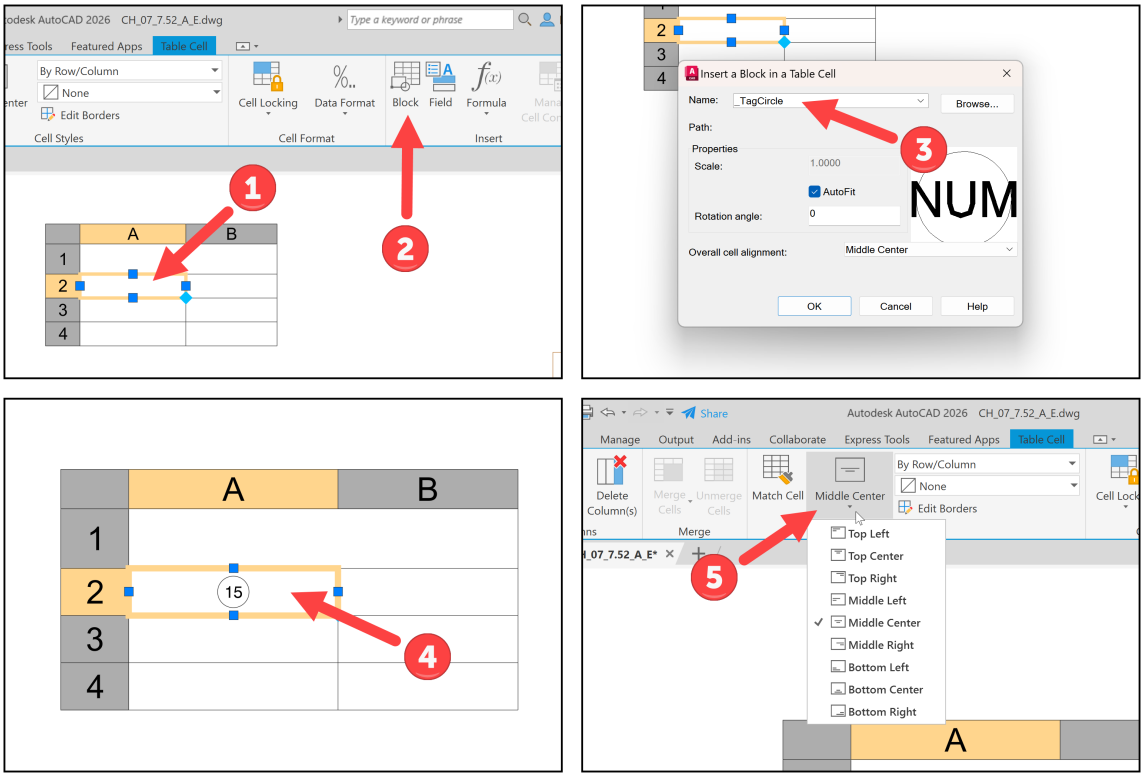

Figure 7.55 - Adding Blocks from Multileaders to a Table

If you have to adjust the height or format of your cells to display Blocks properly, you can use the Properties Palette with a cell selected. This gives us real-time feedback after making changes to the cell properties.

7.5.5 Listing Blocks with Tables and Fields (Expressions)

Working with Tables and Blocks is excellent for explaining data connected to a "Multi-leader," but we can also interact with Blocks as part of your design. A common use of the feature is to make lists of existing Blocks to help control data related to the project. For instance, you might have a list of chairs in a large room or bolts in a machine.

The direction gives us control over the flow of our copies. It usually goes clockwise, but you can change that to counterclockwise by turning off the option.

You can dynamically change the *Array* results using grips. If you look closely at the results of your *Polar Array*, you can see a grip with a small arrow shape. By clicking and dragging this grip, you can change the angle. It is also available for the rows.

5.5.5 Path Array

The last variant for making copies is named *Path Array*, and it works by placing drawings along a path. This could be a simple Line, Polyline, or Spline. A popular use of these copies is in landscaping, where we can take vegetation drawings and place copies along a curved path.

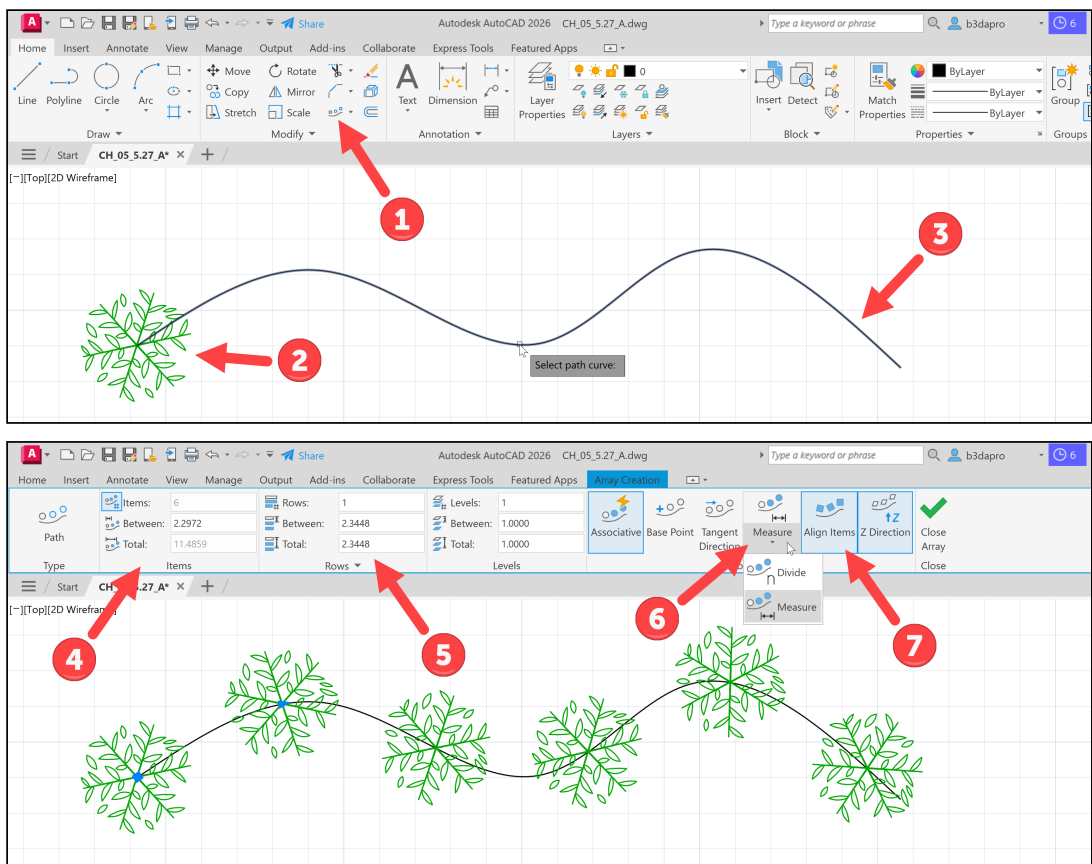

Figure 5.27 - Starting a Path Array

use the zoom controls from your mouse or interface to change and adjust the visualization (3).

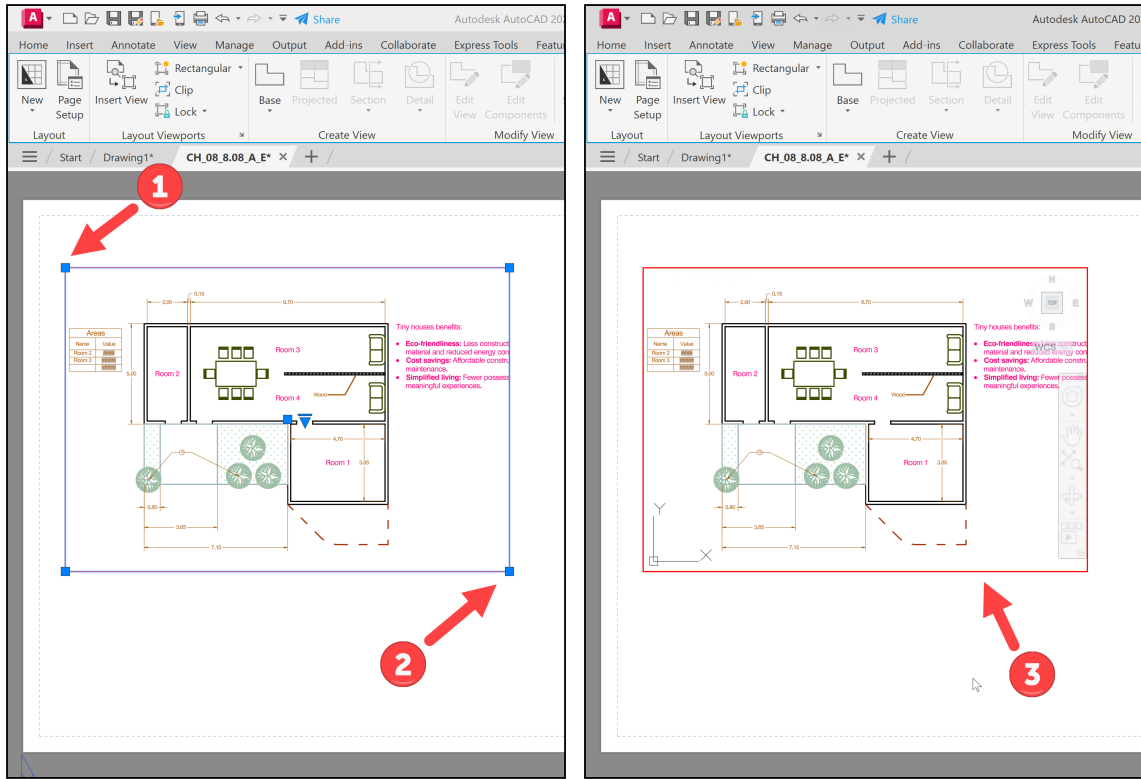

Figure 8.8 - Changing the zoom and scaling in a Viewport

A double-click outside the Viewport area exits the zoom editing and fixes the current visualization. Once you find the zoom that you want to use inside a Viewport, you should avoid changing or updating the Viewport.

The best way to protect your Viewport after finding the correct zoom magnification is with a feature called *Display Lock*.

Enabling the *Display Lock* in a Viewport means you can't change or update the current zoom. How do you determine if a Viewport has a lock on the Zoom? Look at the Status Bar; a padlock icon displays the status of your selected Viewport.